



*FIRST*® IN SHOW<sup>SM</sup>  
presented by Qualcomm

[firstlegoleague.org](http://firstlegoleague.org)

# Louisiana *FIRST* LEGO League State Championship Team Information Packet

## Louisiana FIRST LEGO League State Championship

# Table of Contents

Tournament Date, Time, Location and Contact.....	3
Schedule.....	3
Parking .....	3
Food / Concessions .....	3
Dress .....	4
Team Size .....	4
Team Check-in .....	4
Pit Area.....	5
Coaches' Meeting.....	5
Judging .....	6
Spectators .....	8
Robot Game .....	6
Awards.....	8
Championship Advancement.....	8
What is <i>Gracious Professionalism</i> ®? .....	8
Tournament Cancellation Policy.....	8
Competition Day Checklist .....	9
APPENDIX:	
Tournament Rules and Procedures, Team List with Pit Numbers, Tournament Judging and Match Schedules, Maps, and Concession Menu	

# Louisiana FIRST LEGO League State Championship

## Tournament Date, Time, Location and Contact

**Date:** Saturday, January 27<sup>th</sup>, 2024

**Time:** 7:45 AM – 5:00 PM

**Location:** Jesuit High School, 4133 Banks St, New Orleans, LA 70119

**Tournament Contacts:** Michelle Sanchez, [msanchez@firstpartners.org](mailto:msanchez@firstpartners.org), [sanchez@tulane.edu](mailto:sanchez@tulane.edu) ;  
Annette Oertling (504-583-3657); [aoertling@firstpartners.org](mailto:aoertling@firstpartners.org), [annette@tulane.edu](mailto:annette@tulane.edu)

## Schedule

Time	Activity
7:00am – 7:45am	Volunteer Check-In
7:45am - 8:15am	Team Check-in at Pit Area (Jesuit Commons – enter through school yard)
8:45am - 1:50pm	Judging Sessions (All Judging is CLOSED to Spectators)
9:00am – 2:00pm	Challenge Matches in the Gym (Open to Spectators)
9:00am – 2:00pm	Practice Tables available in Gym – teams must reserve 10min time slot
11:45am–12:30pm	LUNCH (No judging or matches taking place)
2:30pm – 4:00pm	Team Activity in the Gym (Open to Spectators)
4:00pm – 5:00pm	Awards Ceremony (Open to Spectators)

## Parking

Teams may park in the parking lot across Banks Street from the school yard entrance or in the ample parking on the streets surrounding the school. **After 8am**, teams may use their **TEAM ACCESS PASS** (sent via email) to enter the schoolyard for team drop off and are welcome to any remaining parking there. The time restriction on the schoolyard is to allow getting our judges, referees, and other volunteers in place for a timely start. Coaches and/or teams may be dropped off before 8am close to the entrance to the schoolyard on Banks Street by the security guard station.

## Food / Concessions

Breakfast, lunch and concessions will be available onsite in the Cafeteria and Commons Café' (see map for locations and menu for available items for purchase at the end of this packet).

- All hot food (breakfast and lunch) will be in the cafeteria. Drinks and snacks may be purchased in both the Cafeteria and the Commons Café' located in the pit area.
- Breakfast will be 7:45-8:45am. Lunch 11am-1pm. Pre-ordered lunches may be picked up in the cafeteria beginning at 11am. Snacks and drinks are available in Commons Café' 7:45-2pm. No changes or additions may be requested in the pre-ordered lunch line.
- **Pre-orders may use cash or check made out to Pigeon Catering. Purchases onsite are CASH ONLY.** There is an ATM 2 blocks away at the Capital One Bank on Canal and Carrollton.
- **No outside food is allowed in the buildings. Food purchased onsite is allowed only in the Cafeteria and Commons (pit area) of the building.**

## Dress

Dress for all teams is casual. We encourage your team to adopt a fun and unique team identity, which allows others to understand something about your team, your engineering experience, or your Innovation Project. Remember to **HAVE FUN!**

## Team Size

A competitive team consists of a minimum of two (2) and a maximum of ten (10) children. Team members must be between 9-14 yrs of age (as allowed by FIRST).

## Team Check-in

Team check-in will run from 7:45 AM – 8:15 AM.

### EXPRESS CHECK-IN:

- Teams who have **submitted both their \$35 tournament fee AND their team roster** by Wednesday, Jan. 24<sup>th</sup> at noon, may proceed directly to the Wristband Pickup Table in the pits (see Jesuit map at the end of this packet). A list of eligible teams will be sent via email several days ahead of the tournament and will also be posted on the entrance doors. All other teams must proceed to the FLL Team Check-In Table (also shown on map).

### REGULAR CHECK-IN:

Coaches must submit the following for their teams to the team check-in volunteers:

- \$35 Tournament Fee:** Volunteers will verify if the funds have been received; otherwise, payment must be made.
- Team Roster:** Download your team roster from the Team Registration System, print a copy, and bring it to the team check-in. Your roster must show that all team members have a signed Consent and Release Form. A *FIRST* Consent form is required for every team member and coach who will be with the team during the competition day. It is not required for spectators or chaperones. If you are having issues with registering your team members online, please contact Annette Oertling ([aoertling@firstpartners.org](mailto:aoertling@firstpartners.org) or [annette@tulane.edu](mailto:annette@tulane.edu)).

### Your team will receive the following at Team Registration:

- Wristbands:** One wristband will be provided for each team member and two coaches. Your team will only receive two coach wristbands, even if your team works with more than two coaches and mentors. Your team will need to decide which two adults will be spending the day with the students. **NOTE: At least one adult coach is required to supervise the team at all times during the tournament.** Coaches may also pick up spectator wristbands at check in. Alternatively, spectators may pick up their own wristbands in the pits or at the gym entrance, but must show ID to do so (for security purposes).
- Schedule of Events:** Your team will be provided information about the tournament day, including judging and match schedules (also included at the end of this packet).

### SECURITY:

- There will be 4 security guards present for the event,
- every participant and spectator must have a wristband (issued at the event) to gain access,
- there is an overhead crosswalk to go between the school building and a building adjacent to the gym, so students do not have to cross Banks Street at ground level,** and
- only vehicles with an Access Pass may enter the schoolyard. Teams may use the Team Access Pass (sent via email) to drop students off in the schoolyard after 8am (see parking details p.3)

## Pit Area

The Pit is where your team will spend much of their time. This is where you will work on your robot and programming. This is also the area where you can enjoy downtime with your team, get to know other teams, see their robots, and find out about their Innovations Projects. Your team will have access to:

- One standard-sized table
- At least two (2) chairs
- Electricity – There will be 4 charging stations located on the perimeter of the pit area.

We recommend that you bring the following for your team to have in the Pit Area:

- A bin or large bags (like trash bags) to store personal belongings, like coats, under your table
- Your robot and all your robot supplies (attachments and additional building pieces)
- Your laptop computer and power cord
- An extension cord and power strip (optional, as there will be charging stations)
- A box or small bin to carry your robot and attachments to and from the competition area. You must unload all your equipment onto the competition table at official matches.
- Games (there will be long periods of downtime – bring some small games that the team can play when things are slow)

Some Pit Area Rules for you to keep in mind:

- Coaches should refrain from handling the robot, attachments, or the computer. **NOTE: If your team encounters technical difficulty, let someone at the tournament know so that the officials at the event understand why a coach might need to handle a robot or work on the computer.**
- If you choose to bring your own field set for practice, they may NOT be placed in the pits as there is no room. You may use the hallways, as long as you do not block access for walking (fire code). There will be room in the courtyard outside of the pits to set up your field set, but you are responsible for it.

## PRACTICE TABLES ARE IN THE GYM (not in the pit area)

- Remember to be gracious professionals when using a Practice Table:
  - Teams are allowed sign up for only one 10-min time slot at a time. An additional time slot may be reserved once you complete your practice time.
  - **Bring a USB connector for your robot, as Bluetooth is NOT ALLOWED in the gym.**
  - Be mindful of your time and other teams' needs. Please be courteous and allow a team facing a crisis to use your practice time).
  - Reset the Practice Table for the next team.
  - Make sure you check that you do not take a mission model from the Practice Table
  - Offer help to teams that may need it!

## Coaches' Meeting

The Coaches' Meeting will be held **on Thursday, Jan. 25<sup>th</sup> at 5pm on Zoom**. The meeting will be recorded for those that cannot attend, and a link will be sent out immediately after. Please join us to hear important information from the Judge Advisor and Head Referee, understand the flow pattern through the competition area, and take this opportunity to ask questions you may have. At least one team coach should attend this meeting.

Join Zoom Meeting - <https://tulane.zoom.us/j/95996989532?pwd=cXJPeGtjR0VadTh3YU1POE1lQU5ZZz09>  
Meeting ID: 959 9698 9532; Passcode: 294348

## Robot Game

Your team is responsible for knowing and understanding the FIRST LEGO League Challenge Robot Game. All of the game documents can be found on the [FIRST LEGO League website](https://www.firstlegoleague.org). You are required to know the following for the robot competition: Field Setup, Rules, Missions, and Robot Game Updates.

Your team will participate three (3) times at the Tournament. Your Robot Performance score is the highest score your team achieves out of the three official rounds. When competing, please keep in mind that:

- The competition area is surrounded with caution tape with one entrance and one exit, clearly identified with traffic cones and an ENTER and EXIT sign. PLEASE OBEY THESE SIGNS.
- You MUST check in with the queueing team by the field ENTRANCE before each match, ideally at least 10 minutes before.
- When checking in, please know your team number, as that is how the matches are listed.
- Only 4 drivers may be at the competition table at a time. Team members may stand in the competition area in designated areas and may switch out during the match.

**Coaches:** Two coaches will be permitted to join the team on the competition floor, but you must stay behind the line with the team and refrain from actively directing the team during the game. Coaches must not touch or handle the robot or attachments during this time. Consider yourselves spectators with the best spot in the house to watch the game. And keep in mind that the Gracious Professionalism score that referees must give depends on the gracious professionalism of the team and the coaches.

**NOTE: Remote controls are not allowed in the competition area – the gym (This includes Smartphone applications that enable you to control your robot remotely). Bluetooth may not be used in the gym, including at the Practice Tables. Your team could be disqualified if you are found remotely controlling your robot anywhere during the competition or if your Bluetooth is enabled in the competition area!**

Make sure you are ready to compete at least ten (10) minutes prior to your scheduled robot round. Remember to respect the referees and the other teams – and **HAVE FUN!**

## Judging

Team judging begins at 8:45 AM. Each team will be judged within a single judging session. Your team will spend ten (30) minutes with your assigned judging pod. Only team members and two (2) coaches will be allowed into the judging rooms. One team coach will be permitted to videotape the judging session; however, that adult should stay toward the back of the room. Nobody from the team should stand behind the judges. Coaches should be silent observers of the judging process and refrain from influencing the session in any way. Digital support for your judging presentation is allowed and audio-visual equipment is available. **To use the AV equipment, you must BRING YOUR OWN LAPTOP**, which can be connected using the Jesuit HDMI cable at the podium. If you have a MAC, you also must bring an HDMI adaptor for a MAC to connect. The judging schedule is tight. You must be on time for your judging session.

**All cell phones (team members & coaches) must be turned off during the judging sessions.**

Please make sure to review [the rubrics](#) with your team prior to coming to the event. The following outlines what you can expect in each of the judging session:



## Judging Session Flowchart

Teams should demonstrate Core Values in everything they do. The judges are excited to see how they show **teamwork, discovery, inclusion, innovation, impact, and fun** as they present their Innovation Project and Robot Design work.

This is the team's time to shine, so try to settle their nerves and encourage them. Please make sure they don't leave anything in the judging room, including any documentation, when they leave.

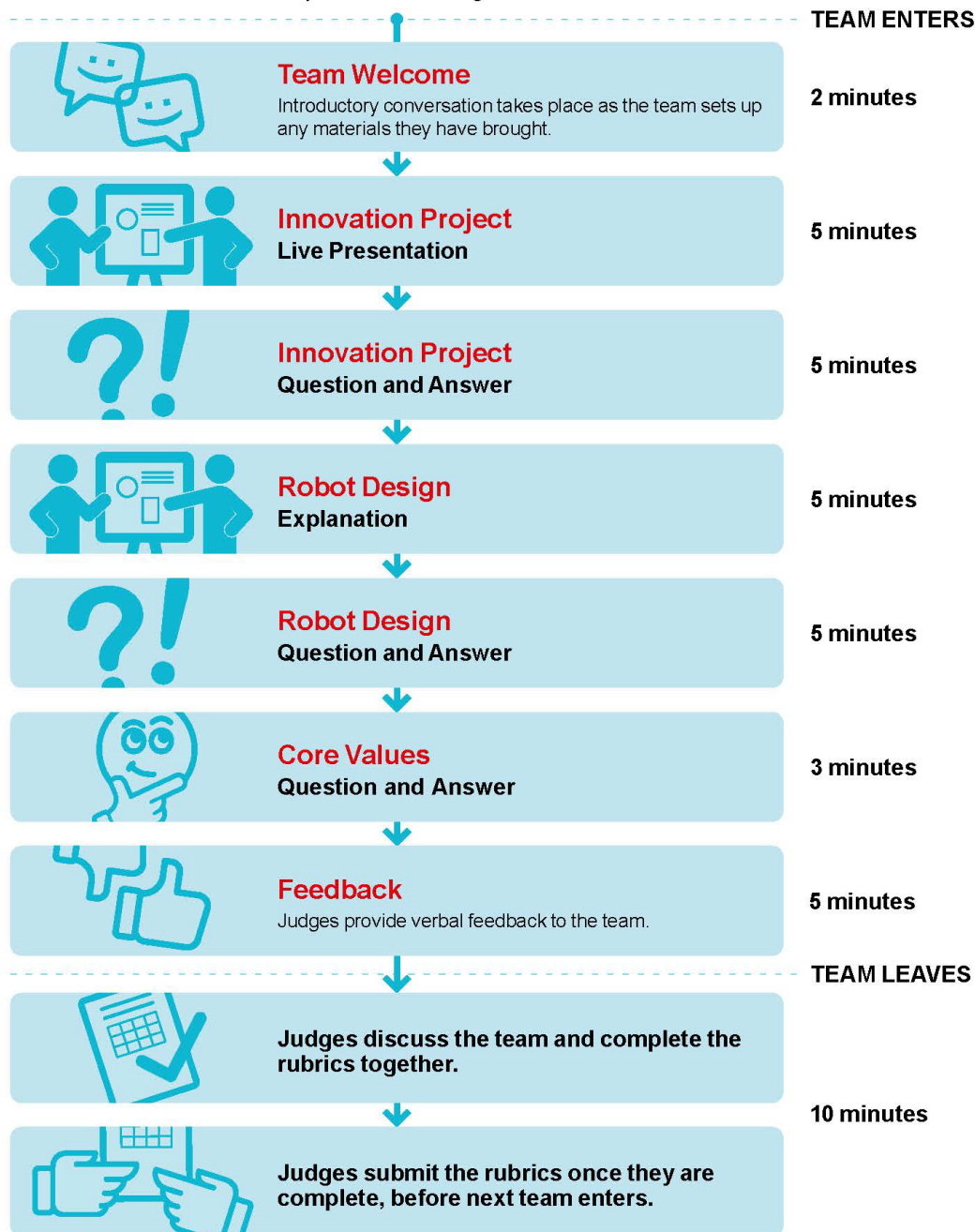



## Spectators

The Robot Game is free and open to spectators with a wrist band, starting at 9:00am. The judging portion of the event, which will happen all morning, is closed to spectators. Thank you for respecting this policy. Please remember to respect the team-only areas – the competition floor area (the area where teams queue and compete) and the judging area. ALL SPECTATORS ARE REQUIRED TO HAVE WRISTBANDS. These spectator wrist bands may be picked up by the coach at team check in, or by spectators later in the day by showing an ID (required for security purposes).

## Awards

Descriptions of FIRST LEGO League Challenge awards can be found [here](#). The following awards will be presented at this tournament:

- 3 Champion's Awards
- 3 each Core Values, Innovation Project, Robot Design, and Robot Performance Awards
- 3 Coach/Mentor Awards
- 3 each Engineering Excellence and Rising Star Awards

## Championship Advancement

Three (3) teams from this tournament will be invited to advance to the:

1. FIRST LEGO League World Festival, which will be held in Houston, Texas, U.S. on April 17-20, 2024, as part of the FIRST Championship
2. WPI FIRST LEGO League Open Event taking place June 7-9<sup>th</sup> in Worcester, MA.
3. FIRST LEGO League Florida Sunshine Invitational on June 19-23<sup>rd</sup>, 2024 at Embry-Riddle Aeronautical University in Daytona Beach, Florida

## What is Gracious Professionalism®?

*Gracious Professionalism*® is part of the ethos of FIRST®. The idea and phrase are found throughout FIRST, but no one has been a stronger champion than FIRST Executive Advisory Board Co-Chair & Distinguished Advisor, Dr. Woodie Flowers. “*Gracious Professionalism* is a way of doing things that encourages high-quality work, emphasizes the value of others, and respects individuals and the community. With *Gracious Professionalism*, fierce competition and mutual gain are not separate notions. Gracious Professionals learn and compete like crazy but treat one another with respect and kindness in the process.”

We expect all team members, volunteers, coaches, and families to behave as Gracious Professionals.

## Tournament Cancellation Policy

The Louisiana FIRST LEGO League State Championship may be canceled or delayed due to causes and conditions beyond the tournament organizers' control, including, but not limited to inclement weather, acts of nature, government restrictions, and/or any other cause beyond the tournament organizers' control. Please refer to local news and radio for current county advisories. If the event must be canceled, it may not be possible to reschedule, and if so, advancement to national events will be determined by lottery of teams registered for this event.



## Competition Day Checklist

	Team Roster
	Robot, attachments, extra parts
	Fresh batteries/spare batteries/rechargeable battery charger
	Computer and battery (if available) and power cord
	USB download cable ( <i>Bluetooth use is NOT permitted on the competition floor</i> )
	Extension cord and power strip
	Box to carry robot to competition field
	Bin to hold personal and team items (coats, games, etc.) to fit under pit table
	Project judging materials, props, and displays
	Graphics demonstrating programming strategy for robot design judging
	Team games or activities for downtimes (optional)
	Team banner or poster to carry for ceremonies or for pit space (optional)
	Team giveaways (optional)

### APPENDIX Attached:

**Tournament Rules and Procedures**

**Team List with Pit Numbers**

**Tournament Judging and Match Schedules**

**Map - Layout of Tournament**

**Concession Menu**

# 2023/24 LA FIRST® LEGO® League STATE CHAMPIONSHIP

## RULES AND PROCEDURES

1. ALWAYS USE **GRACIOUS PROFESSIONALISM!**
2. To enter the facilities, **every attendee (including spectators) MUST WEAR A WRISTBAND**, which may be picked up by the team coach at check-in or at the volunteer table. Anyone entering without a wristband must sign in and show I.D. to obtain one. A spectator wristband may also be obtained at the Pit Admin Table in the Commons or Information Table in the Gym - with ID required.
3. An adult coach must accompany all teams, and **an adult MUST ALWAYS accompany students**, including in the pits. The coach is responsible for the general decorum of the members of the team at all times during the tournament. FIRST LEGO League Challenge judging is on the 2<sup>nd</sup> floor, **The 3<sup>rd</sup> and 4<sup>th</sup> floors are off-limits to everyone.** Teams not adhering to this risk disqualification. While the atmosphere is casual, exciting, and loud, we expect all attendees to behave in a responsible manner. Proper dress will be required of all attendees. Casual wear including jeans, t-shirts and sneakers are recommended.
4. Should it become necessary to ask a member of a team to leave, the team coach will be responsible to see that the ejected member is released to a responsible adult; or in the alternative, the entire team will be disqualified from the tournament. **Children accompanying teams MUST BE SUPERVISED AT ALL TIMES – INCLUDING OUTSIDE.**
5. A Team Roster with confirmation of signed release forms must be submitted at check-in prior to the team being admitted for the event on tournament day.
6. Each FLL team should bring their robot, their laptop computer and any other accessories or equipment they need in order to present/participate in the competition. Digital support for your judging presentation is allowed and audio-visual equipment is available. **To use the AV equipment, you must BRING YOUR OWN LAPTOP**, which can be connected using the Jesuit HDMI cable at the podium. If you have a MAC, you also must bring an HDMI adaptor for a MAC to connect. If you choose to bring your own field set for practice, they may NOT be placed in the pits as there is no room. You may use the hallways, as long as you do not block access for walking (fire code). There will be room in the courtyard outside of the pits to set up your field set, but you are responsible for it. Challenge tables will also be available for practice throughout the day, and sign-up will be available. **Only 2 adults with coach wristbands are allowed in the judging room with their team. And during 30 minute official judging window, coaches are welcome to discretely record their session.**
7. **Each team must present itself on time at the proper judging room or challenge table in order to be considered for scoring in that particular event.** Should the team arrive late for judging, it will only be allocated the time remaining in its time slot for judging purposes. Should the team arrive late for its challenge match, it will not be able to participate in that round of the challenge.
8. **No food or beverages will be permitted inside the gym or in the main building, except for the Cafeteria and Commons Room (pit area). Food or liquid may NOT be brought into the classrooms used for judging.** Breakfast, lunch and snacks will be available for sale in the cafeteria. Snacks and drinks will be available in the Commons Café' (pit area). Breakfast will be available from 7:45-8:45am, and lunch from 11am-1pm. Commons Café is open 7:45am-2pm. Team pre-orders may be picked up in the CAFETERIA after 11am. Outside food may not be brought into the building. This includes ice. PLEASE USE GARBAGE CANS FOR TRASH. No glass bottles will be permitted on the premises.
9. No smoking, drugs, alcoholic beverages or weapons of any kind are permitted.
10. All decisions regarding judging are the sole responsibility of the tournament official judges and their decisions will be considered final.

## 2023/24 Louisiana FIRST LEGO League State Championship Teams

Team Number	Pit #	Team Name	Organization Name	City
2583	28	Dragoneer Robotics	St. Dominic School	New Orleans
4043	59	Bayou Builders	HYPE Robotics	Hammond
4249	41	St. Theresa Warrior Robots Sr	St. Theresa Middle School	Gonzales
7394	3	Greenie Gators	Isidore Newman School	New Orleans
8222	21	Fatima Warriors 2	Our Lady of Fatima School	Lafayette
23645	43	A-Team Sharks	Athlos Academy of Jefferson Parish	Gretna
25379	40	Saints Robotics	St. Michael School	Crowley
26595	19	Knights	Lafayette Christian Academy	Lafayette
31362	41A	St. Theresa Warrior Robots Jr	St. Theresa Middle School	Gonzales
32504	39	Patriots	Our Lady of Prompt Succor School	Chalmette
33564	56	Brainiacs	Little Oak Middle	Slidell
34395	12	MakerWay	KIPP Central City Academy	New Orleans
38555	45	ECW LEGO Lions	Emily C. Watkins Elementary	LaPlace
38999	42	Robotic Wolves	Coteau Bayou Blue	Gray
42848	58	VAL Eagle Robotics	Virtual Academy of Lafourche	Thibodaux
43433	13	RoyalBots	Kipp Leadership Academy	New Orleans
44449	49	SCS Gator Robotics	St. Catherine of Siena Catholic School	Metairie
45346	52	Bullion Bear Bots	Bullion Primary School	Prairieville
46895	47	RKS Robotics	R. K. Smith Middle School	LULING
51125	9	Space Ninjas	STEM and Robotics Center, TECH Robotics	Covington
51730	1	1st Bear Bots	Bluff Middle School	Prairieville
51903	44	Gator Bots	Bayou Blue Middle School	Houma
51907	46	Larose Cut Off Middle School	Larose-Cut Off Middle School	Larose
51909	54	Raceland Middle School	Raceland Middle School	Raceland
55887	34	Atlas Tigers	Atlas Foundation	Baton Rouge
56065	24	Robojays Blue Team	Oak Grove Primary	Prairieville
56066	25	Robojays Yellow Team	Oak Grove Primary	Prairieville
56446	32	Hornets	Walnut Hill Middle School	Shreveport
56596	18	Robot Specialist	Community Team	Broussard
56846	38	Nunez Robotics 2	Nunez Community College	Chalmette
56920	14	KIPP East Boltz	Kipp East Academy	New Orleans

## 2023/24 Louisiana FIRST LEGO League State Championship Teams

Team Number	Pit #	Team Name	Organization Name	City
57193	30	Spartans	Caldwell Parish Junior High	Columbia
57429	53	PantherBots	Prairieville Middle School	Prairieville
57886	20	Knights 2	Lafayette Christian Academy	LAFAYETTE
58370	36	Belle Chasse Academy Eaglelizers	Belle Chasse Academy	Belle Chasse
58410	61	Flaming Flamingos	HYPE Robotics	Hammond
58411	60	Purple Glitch	HYPE Robotics	Hammond
58660	16	Generation Spark Purple Bots	Operation Spark	New Orleans
58985	17	Generation Spark Yellow Bots	Operation Spark	New Orleans
58995	33	Spartan Hurricanes 1	Youree Drive Middle School	Shreveport
59168	2	Biotic Bears	Bluff Middle School	Prairieville
59477	48	ICE Cube Blue	Immaculate Conception School	Marrero
60905	31	Big Green Shreks	Donnie Bickham Middle School	Shreveport
61074	37	BattleJacks	YMCA of Bogalusa	Bogalusa
61101	50	STEMgineers	St. George's Episcopal School	New Orleans
61194	29	St. Dominic School Lego Dragons	St. Dominic School	New Orleans
61276	55	NEXT LEVEL Robotics	Community	Slidell
61413	35	Little Guppies	Episcopal School of Baton Rouge	Baton Rouge
61562	7	RAMS	ST. ANGELA MERICI	Metairie
61563	8	SAMRAMS	ST. ANGELA MERICI	Metairie
61919	15	Voodoo 6701	Mildred Osborne Charter School	New Orleans
62061	4	Newman Middle School	Isidore Newman School	New Orleans
62498	10	The Night Furies	STEM and Robotics Center	Covington
62922	51	Cosmic Colonels	Starbase Jackson Barracks	New Orleans
62982	11	Bob and Gary	STEM and Robotics Center	Covington
63084	26	MMS Galactic Hackers	Mandeville Middle School	Mandeville
63086	27	Blue Lightning	Mandeville Middle School	Mandeville
63741	57	Warrior Robotics 2	Thibodaux Middle School	Thibodaux
63949	22	Lords of the LEGOS	Acadiana Renaissance Charter Academy	Youngsville
63950	23	FIRST LEGO Defeaters	Acadiana Renaissance Charter Academy	Youngsville

## January 27, 2024 FLL Louisiana State Championship Judging Schedule

	Judging Pod									
	1	2	3	4	5	6	7	8	9	10
	Room 214	Room 216	Room 219	Room 220	Room 221	Room 222	Room 223	Room 224	Room 227	Room 229
8:45 AM	63084	26595	43433	62498	63950	46895	58410	59477	57193	51903
9:25 AM	34395	56596	63741	58370	4043	38999	57886	61413	56066	45346
10:05 AM	Break	Break	Break	Break	Break	Break	Break	Break	Break	Break
10:15 AM	63949	62061	58985	61194	51125	62922	58660	55887	4249	38555
10:55 AM	61276	23645	25379	42848	33564	51909	58411	2583	56846	57429
11:35 AM	Lunch	Lunch	Lunch	Lunch	Lunch	Lunch	Lunch	Lunch	Lunch	Lunch
12:30 PM	63086	61562	58995	59168	61563	56065	61101	56446	61919	31362
1:10 PM	8222	44449	32504	51730	62982	60905	56920	61074	51907	7394
1:50 PM	END									

	LA State Championship Robot Challenge Matches							
	Teams		Teams		Teams		Teams	
	Table 1	Table 2	Table 3	Table 4	Table 5	Table 6	Table 7	Table 8
9:00:00 AM	63086	61562			61563	56065		
9:03:00 AM			58995	59168			61101	56446
9:06:00 AM	61919	31362			32504	51730		
9:09:00 AM			8222	44449			62982	60905
9:12:00 AM	56920	61074			51907	7394		
9:15:00 AM								
9:18:00 AM			63949	62061			51125	62922
9:21:00 AM	58985	61194			58660	55887		
9:24:00 AM			4249	38555			25379	42848
9:27:00 AM	61276	23645			33564	51909		
9:30:00 AM			58411	2583			56846	57429
10:00:00 AM	56065	63086			61562	61563		
10:03:00 AM			56446	58995			59168	61101
10:06:00 AM	51730	61919			31362	32504		
10:09:00 AM			60905	8222			44449	62982
10:12:00 AM	7394	56920			61074	51907		
10:30:00 AM			63084	26595			63950	46895
10:33:00 AM	43433	62498			58410	59477		
10:36:00 AM			57193	51903			63741	58370
10:39:00 AM	34395	56596			4043	38999		
10:42:00 AM			57886	61413			56066	45346
11:15:00 AM	61562	61563			56065	63086		
11:18:00 AM			59168	61101			56446	58995
11:21:00 AM	31362	32504			51730	61919		
11:24:00 AM			8222	62982			60905	44449
11:27:00 AM	61074	51907			7394	56920		
11:30:00 AM			46895	63084			26595	63950
11:33:00 AM	59477	43433			62498	58410		
11:36:00 AM			58370	57193			51903	63741
11:39:00 AM	38999	34395			56596	4043		
11:42:00 AM			45346	57886			61413	56066
12:45:00 PM	62922	63949			62061	51125		
12:48:00 PM			55887	58985			61194	58660
12:51:00 PM	42848	4249			38555	25379		
12:54:00 PM			51909	61276			23645	33564
12:57:00 PM	57429	58411			2583	56846		
1:15:00 PM			43433	63950			63084	59477
1:18:00 PM	26595	58410			46895	62498		
1:21:00 PM			57193	63741			58370	51903
1:24:00 PM	4043	61413			34395	57886		
1:27:00 PM			38999	56066			45346	56596
1:45:00 PM	63949	51125			62922	62061		
1:48:00 PM			58985	58660			55887	61194
1:51:00 PM	4249	25379			42848	38555		
1:54:00 PM			61276	33564			51909	23645
1:57:00 PM	58411	56846			57429	2583		
2:00:00 PM	END							

## Louisiana FIRST Lego League Championship - Individual Team Schedules

Pit Number	Team Number	Team Name	Project	Round 1	Round 2	Round 3
28	2583	Dragoneer Robotics	10:55:00 AM	9:30:00 AM	12:57:00 PM	1:57:00 PM
59	4043	Bayou Builders	9:25:00 AM	10:39:00 AM	11:39:00 AM	1:24:00 PM
41	4249	St. Theresa Warrior Robots Sr	10:15:00 AM	9:24:00 AM	12:51:00 PM	1:51:00 PM
3	7394	Greenie Gators	1:10:00 PM	9:12:00 AM	10:12:00 AM	11:27:00 AM
21	8222	Fatima Warriors 2	1:10:00 PM	9:09:00 AM	10:09:00 AM	11:24:00 AM
43	23645	A-Team Sharks	10:55:00 AM	9:27:00 AM	12:54:00 PM	1:54:00 PM
40	25379	Saints Robotics	10:55:00 AM	9:24:00 AM	12:51:00 PM	1:51:00 PM
19	26595	Knights	8:45:00 AM	10:30:00 AM	11:30:00 AM	1:18:00 PM
39	32504	Patriots	1:10:00 PM	9:06:00 AM	10:06:00 AM	11:21:00 AM
56	33564	Brainiacs	10:55:00 AM	9:27:00 AM	12:54:00 PM	1:54:00 PM
12	34395	MakerWay	9:25:00 AM	10:39:00 AM	11:39:00 AM	1:24:00 PM
45	38555	ECW LEGO Lions	10:15:00 AM	9:24:00 AM	12:51:00 PM	1:51:00 PM
42	38999	Robotic Wolves	9:25:00 AM	10:39:00 AM	11:39:00 AM	1:27:00 PM
41A	31362	St. Theresa Warrior Robots Jr	12:30:00 PM	9:06:00 AM	10:06:00 AM	11:21:00 AM
58	42848	VAL Eagle Robotics	10:55:00 AM	9:24:00 AM	12:51:00 PM	1:51:00 PM
13	43433	RoyalBots	8:45:00 AM	10:33:00 AM	11:33:00 AM	1:15:00 PM
49	44449	SCS Gator Robotics	1:10:00 PM	9:09:00 AM	10:09:00 AM	11:24:00 AM
52	45346	Bullion Bear Bots	9:25:00 AM	10:42:00 AM	11:42:00 AM	1:27:00 PM
47	46895	RKS Robotics	8:45:00 AM	10:30:00 AM	11:30:00 AM	1:18:00 PM
9	51125	Space Ninjas	10:15:00 AM	9:18:00 AM	12:45:00 PM	1:45:00 PM
1	51730	1st Bear Bots	1:10:00 PM	9:06:00 AM	10:06:00 AM	11:21:00 AM
44	51903	Gator Bots	8:45:00 AM	10:36:00 AM	11:36:00 AM	1:21:00 PM
46	51907	Larose Cut Off Middle School	1:10:00 PM	9:12:00 AM	10:12:00 AM	11:27:00 AM
54	51909	Raceland Middle School	10:55:00 AM	9:27:00 AM	12:54:00 PM	1:54:00 PM
34	55887	Atlas Tigers	10:15:00 AM	9:21:00 AM	12:48:00 PM	1:48:00 PM
24	56065	Robojays Blue Team	12:30:00 PM	9:00:00 AM	10:00:00 AM	11:15:00 AM
25	56066	Robojays Yellow Team	9:25:00 AM	10:42:00 AM	11:42:00 AM	1:27:00 PM
32	56446	Hornets	12:30:00 PM	9:03:00 AM	10:03:00 AM	11:18:00 AM
18	56596	Robot Specialist	9:25:00 AM	10:39:00 AM	11:39:00 AM	1:27:00 PM
38	56846	Nunez Robotics 2	10:55:00 AM	9:30:00 AM	12:57:00 PM	1:57:00 PM



## Louisiana FIRST Lego League Championship - Individual Team Schedules

<b>Pit Number</b>	<b>Team Number</b>	<b>Team Name</b>	<b>Project</b>	<b>Round 1</b>	<b>Round 2</b>	<b>Round 3</b>
14	56920	KIPP East Boltz	1:10:00 PM	9:12:00 AM	10:12:00 AM	11:27:00 AM
30	57193	Spartans	8:45:00 AM	10:36:00 AM	11:36:00 AM	1:21:00 PM
53	57429	PantherBots	10:55:00 AM	9:30:00 AM	12:57:00 PM	1:57:00 PM
20	57886	Knights 2	9:25:00 AM	10:42:00 AM	11:42:00 AM	1:24:00 PM
36	58370	Belle Chasse Academy Eaglelizers	9:25:00 AM	10:36:00 AM	11:36:00 AM	1:21:00 PM
60	58411	Purple Glitch	10:55:00 AM	9:30:00 AM	12:57:00 PM	1:57:00 PM
16	58660	Generation Spark Purple Bots	10:15:00 AM	9:21:00 AM	12:48:00 PM	1:48:00 PM
17	58985	Generation Spark Yellow Bots	10:15:00 AM	9:21:00 AM	12:48:00 PM	1:48:00 PM
33	58995	Spartan Hurricanes 1	12:30:00 PM	9:03:00 AM	10:03:00 AM	11:18:00 AM
2	59168	Biotic Bears	12:30:00 PM	9:03:00 AM	10:03:00 AM	11:18:00 AM
48	59477	ICE Cube Blue	8:45:00 AM	10:33:00 AM	11:33:00 AM	1:15:00 PM
61	58410	Flaming Flamingos	8:45:00 AM	10:33:00 AM	11:33:00 AM	1:18:00 PM
31	60905	Big Green Shreks	1:10:00 PM	9:09:00 AM	10:09:00 AM	11:24:00 AM
37	61074	BattleJacks	1:10:00 PM	9:12:00 AM	10:12:00 AM	11:27:00 AM
50	61101	STEMgineers	12:30:00 PM	9:03:00 AM	10:03:00 AM	11:18:00 AM
29	61194	St. Dominic School Lego Dragons	10:15:00 AM	9:21:00 AM	12:48:00 PM	1:48:00 PM
55	61276	NEXT LEVEL Robotics	10:55:00 AM	9:27:00 AM	12:54:00 PM	1:54:00 PM
35	61413	Little Guppies	9:25:00 AM	10:42:00 AM	11:42:00 AM	1:24:00 PM
7	61562	RAMS	12:30:00 PM	9:00:00 AM	10:00:00 AM	11:15:00 AM
8	61563	SAMRAMS	12:30:00 PM	9:00:00 AM	10:00:00 AM	11:15:00 AM
15	61919	Voodoo 6701	12:30:00 PM	9:06:00 AM	10:06:00 AM	11:21:00 AM
4	62061	Newman Middle School	10:15:00 AM	9:18:00 AM	12:45:00 PM	1:45:00 PM
10	62498	The Night Furies	8:45:00 AM	10:33:00 AM	11:33:00 AM	1:18:00 PM
51	62922	Cosmic Colonels	10:15:00 AM	9:18:00 AM	12:45:00 PM	1:45:00 PM
11	62982	Bob and Gary	1:10:00 PM	9:09:00 AM	10:09:00 AM	11:24:00 AM
26	63084	MMS Galactic Hackers	8:45:00 AM	10:30:00 AM	11:30:00 AM	1:15:00 PM
27	63086	Blue Lightning	12:30:00 PM	9:00:00 AM	10:00:00 AM	11:15:00 AM
57	63741	Warrior Robotics 2	9:25:00 AM	10:36:00 AM	11:36:00 AM	1:21:00 PM
22	63949	Lords of the LEGOS	10:15:00 AM	9:18:00 AM	12:45:00 PM	1:45:00 PM
23	63950	FIRST LEGO Defeaters	8:45:00 AM	10:30:00 AM	11:30:00 AM	1:15:00 PM

Palmyra Street

Concessions

Stairs to  
Judges' Rooms

Men's

Women's

Cafeteria

Elevator

FLL Pits  
(Commons)

Express Team  
Check-in

FLL Team  
Check-in

Wristband  
Pickup Table

Volunteer  
Entrance

Commons Cafe

Volunteer  
Lounge

Stairs to  
Judges' Rooms

Volunteer Check-in

Stairs to  
bridge

AUDITORIUM

Volunteer Parking

Team Drop Off and Limited Team  
Parking Available after 8am

FLL Main  
Entrance

Elevator

JHS - 1<sup>st</sup> Floor

Banks Street

**\*\*ONLY cross over to gym using the bridge on the 2nd floor\*\***

Solomon Street

S Carrollton Ave

Palmyra Street

Solomon Street

S Carrollton Ave

Banks Street



Bridge to Gym



Women's 226

JHS – 2<sup>nd</sup> Floor

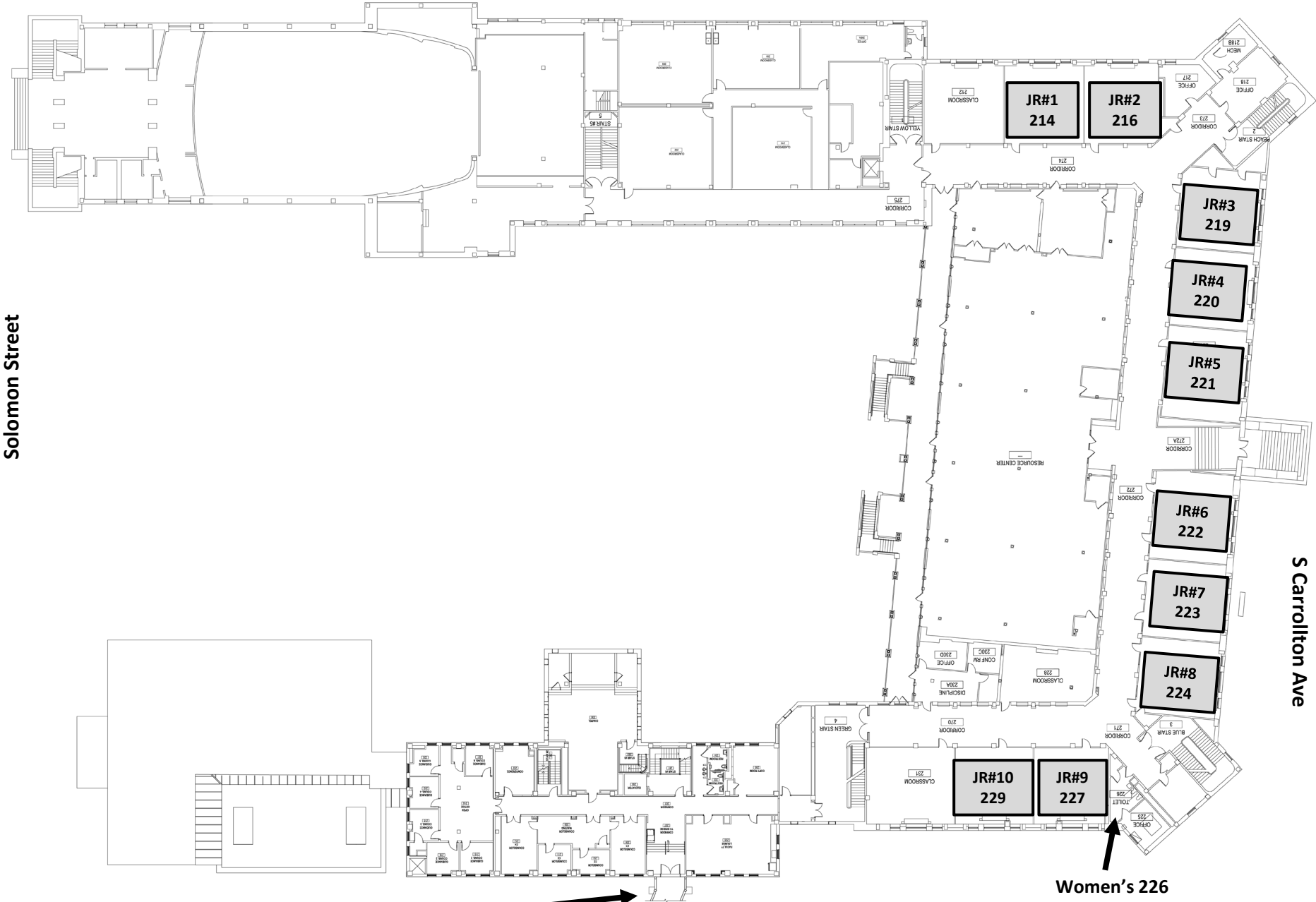

# Louisiana FIRST LEGO League Robotics State Tournament

## menu

**lunch**

Hamburger	<b>4.00</b>	----
Cheeseburger	<b>4.25</b>	----
Fried Chicken Sandwich	<b>4.00</b>	----
Spicy Chicken Sandwich	<b>4.00</b>	----
French Fries	<b>2.50</b>	----
Turkey Sandwich	<b>3.50</b>	----
Ham Sandwich	<b>3.50</b>	----
Chicken Nuggets	<b>4.50</b>	----
Canned Drinks	<b>1.75</b>	----
Coke		----
Diet Coke		----
Sprite		----
Barq's		----
Bottle Water	<b>1.50</b>	----
Lay's Chips	<b>1.50</b>	----

Lunch may be pre-ordered by Thursday, Jan. 18th , 11:59pm,  
and paid at pick-up with cash or checks made out to Pigeon Catering.

**LUNCH PRE-ORDER LINK.**

All onsite purchases are CASH ONLY.



**Pigeon Catering**

# Louisiana FIRST LEGO League Robotics State Tournament

## menu

### breakfast

French Toast w/ syrup	3.50	----
Muffins	3.25	----
Sausage Egg & Cheese Biscuit	3.25	----
Bacon Egg & Cheese Biscuit	3.25	----
Donut	1.35	----
Apple Fritter	2.50	----
Cinnamon Rolls	2.50	----



**Pigeon Catering**

Breakfast items may only be purchased onsite.

All onsite purchases are CASH ONLY.

Breakfast and lunch will be served in the cafeteria. Snacks and drinks (only) are available in the Commons Café'.